

COALBUSH'S Tipping Point

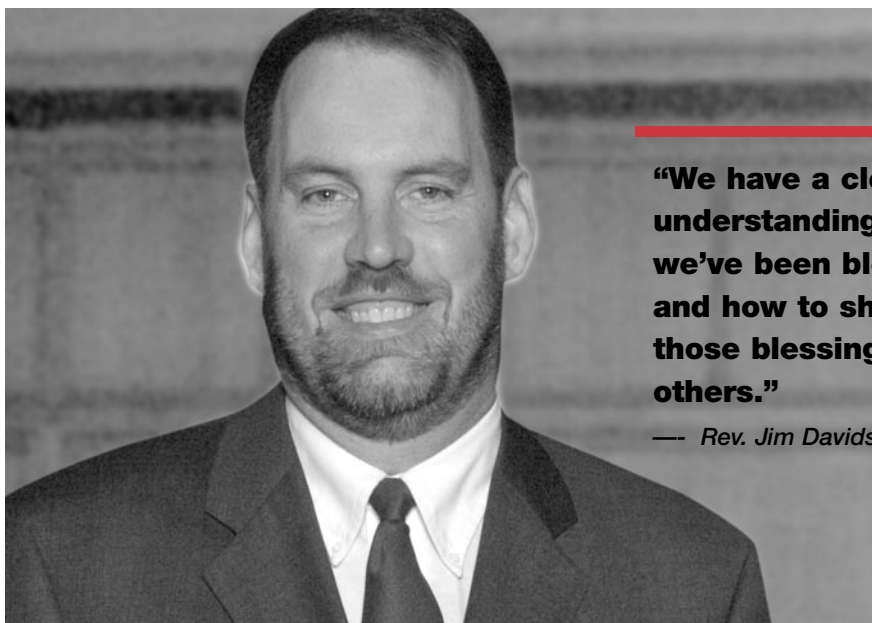

“We have a clear understanding of how we’ve been blessed and how to share those blessings with others.”

— Rev. Jim Davidson, Pastor

Sometimes the best laid plans take a little extra time.

When Coalbush United Methodist Church in Mishawaka, Indiana, decided they needed to erect a new Christian education addition, the congregation was ready... the floor plan was not. “Our people were very motivated,” said Coalbush pastor, Rev. Jim Davidson. “This project was largely lay-driven, and our people provided the framework for success.” But when delays occurred with the project floor plan, Church Growth Services principal, Dick Beall, recommended that the campaign be temporarily suspended. “It was unprecedented to postpone a campaign that was well under way, but we wanted to make sure the congregation had drawings that effectively captured what they could afford and envision.” Once the drawings came in, the campaign resumed with the same vigor as before, if not more, with over \$600,000 being raised for the campaign goal of \$400,000.

“Communication was the most critical aspect and always emphasized,” Davidson asserted. “We kept the congregation fully informed not only during the

campaign activities, but also during the building process.”

While Coalbush was already a very welcoming congregation, Davidson sees a renewed sense of purpose being birthed during the campaign. “People take pride in what we’re doing. Our congregation is excellent at inviting and welcoming new people. Our commitment to minister to those coming to Coalbush is stronger than ever.”

Even Davidson himself has experienced a personal renewal. “This process and experience has helped me refocus my ministry to the people at Coalbush and has added longevity to my pastorate.”

Future plans for additional growth are already being talked about. And why not? “The Lord’s presence was evident throughout the campaign,” Davidson said. More good things surely await Coalbush. And this first time around, it certainly was worth the wait. ■

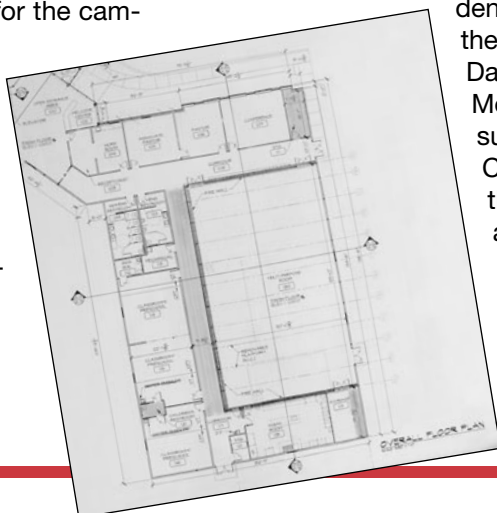

With over 45 years of experience, Church Growth Services is one of the nation’s leading stewardship consulting firms. CGS will help you know your campaign will be successful before you launch it.

They are ready to coach and encourage you on your way to a successful stewardship campaign.

**CHURCH
GROWTH
SERVICES**

Capital Giving Specialists

DEVELOPING STEWARDS, CHANGING LIVES

Church Growth Services
P.O. Box 2409
South Bend, IN 46680-2409

800-234-9853 · 574-291-4777
Stewardship@churchgrowthservices.com
www.churchgrowthservices.com

Your Stewardship Tipping Point

Jesus was always careful to warn people to count the cost. Decisions that call for commitment need prayer and discussion. When you decide to move forward with your next debt-reduction or capital campaign, remember that the tipping point in your campaign begins and ends with God. Remember, too,

that campaign success is about more than just forming the committees. It starts with the pre-campaign assessment. Church Growth Services' pre-campaign assessments will help you count the cost and eliminate a false start. You can discuss your campaign tipping point with a CGS consultant today. They've been coaching churches for more than 45 years.

Coalbush United Methodist

Coalbush United Methodist Church to introducing people to the love of God in Jesus Christ and helping them grow in their relationship with him.

15977 Jackson Road
Mishawaka, Indiana 46544
(574) 259-4136

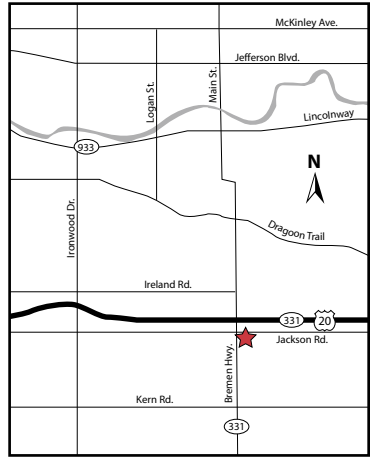

Church Growth Services
P.O. Box 2409
South Bend, IN 46680-2409

Capital Giving Specialists

**CHURCH
GROWTH
SERVICES**

COALBUSH'S Tipping Point